

Your Partner for Trade Fairs and Events

# INNER VALUES

ABOUT MESSE DÜSSELDORF



Messe  
Düsseldorf



## POINT OF SALE

Since 1971, we have provided our customers with superb trade fair grounds, designed to provide high levels of functionality, flexibility and excellent facilities. Technical equipment, architecture and service – as the trade fair industry changes, so do we.

And we do so with one goal in mind: to secure the position of our home base as one of the most modern, multifunctional trade fair and event locations, both now and in the future. To this end, our focus is on flexible exhibition spaces, high quality seminar, conference and convention rooms close to the trade fair halls, and constant improvements of the grounds for our customers. Add to this, state of the art technology and organisational facilities designed to reduce consumption of resources.

However, our focus is also on our many employees, our specialists who are there for you – with a great deal of experience and even more enthusiasm. And, best of all, we provide you with just one contact person to answer any questions you may have concerning your event.

» [www.messe-duesseldorf.com](http://www.messe-duesseldorf.com)



# OUR ASSETS

## 7 GOOD REASONS TO LET MESSE DÜSSELDORF HOST YOUR EVENT

1

EXPERTISE  
AND EXPERIENCE  
IN ORGANISING  
TRADE FAIRS

2

FULL SERVICE  
IN ALL SECTORS  
AND FIELDS

3

IDEAL GROUNDS AND  
HALL INFRASTRUCTURE

4

SHORT-DISTANCE  
TRAFFIC  
INFRASTRUCTURE

5

MODERN CONVENTION  
FACILITIES

6

COSMOPOLITAN  
URBAN ENVIRONMENT

7

AT THE HEART  
OF A STRONG  
ECONOMIC REGION



# IDEASPACE

## OVERVIEW

- › Inaugurated 1971
- › Exhibition space 304,817 sqm
- › Indoor exhibition space 261,817 sqm
- › Outdoor exhibition space 43,000 sqm

» [www.messe-duesseldorf.com/site\\_halls](http://www.messe-duesseldorf.com/site_halls)

» New construction of the south entrance and trade fair hall 1: 06/2017 until 08/2019

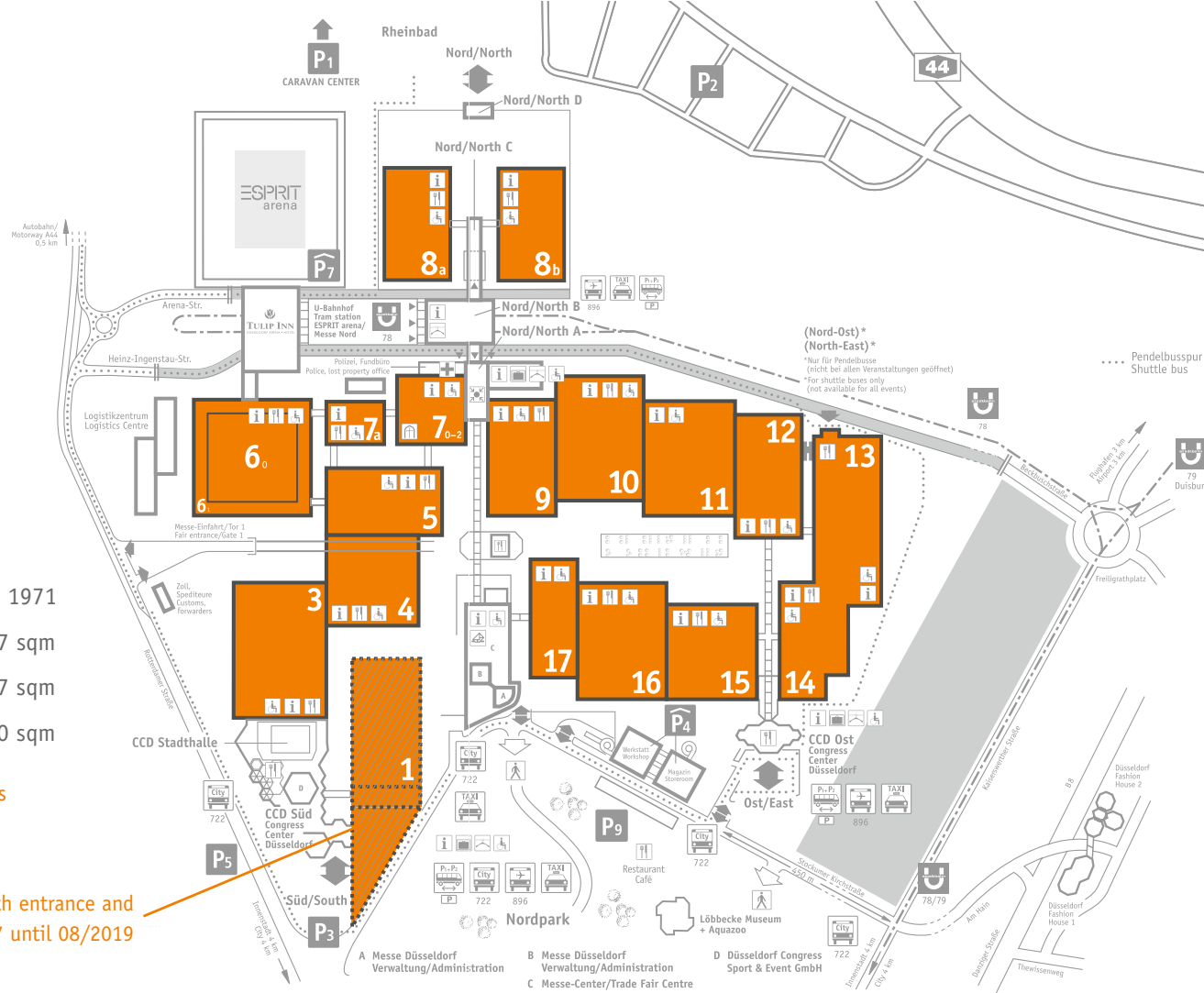

## HALL VERSATILITY

- › Number 18
- › Floor area 3,883 – 25,276 sqm
- › Ceiling heights 8 – 26 m
- › Floor loading capacity 10 t/sqm (distributed weight, ground level)
- › Suspended load capacities Max. 50 kg per suspension point (approx. every 3 m)
- › Hall entrances 149 (W/H: 4.50 – 8.45 m / 4.10 – 7.40 m)
- › Large entrances 3  
11.10 m / 12.00 m (halls 15/16)  
13.35 m / 15.50 m (hall 6)
- › Technical logistics for stands: walk-in utility ducts every 30 m, utility ducts for compressed air, power and water supply, and communications equipment every 5 m

## NO IMPEDIMENTS

- › Guests with disabilities can rely on the superior infrastructure of our grounds.



## EMPOWERING

FULL SERVICE FROM A-Z.  
ONE CONTACT PERSON TO ANSWER  
ALL OF YOUR QUESTIONS.

### KEY SERVICES

- › Stand construction/technical equipment
- › Infrastructure/catering
- › Marketing/communications/PR

### FACILITIES

- › Restaurants and snack bars, both in the halls and around the grounds
- › Travel agency, supermarket, postal service, hair salon, photo store, etc. in the mall and trade fair centre
- › First aid station at the north entrance
- › Prayer room/chapel in hall 7
- › Trade fair centre with exhibitor services
- › Additional customer areas (guest club, international lounge, press club)

» [www.messe-duesseldorf.com/sabc\\_gb](http://www.messe-duesseldorf.com/sabc_gb)

## CLOSE AT HAND

### WELL CONNECTED

- › Car/lorry Direct motorway access  
20,000 parking spaces  
with shuttle busses
- › Airport 1.8 miles / 10 min. by bus/taxi  
to Düsseldorf Airport
- › Public transit Underground station at north entrance  
20 min. to Düsseldorf main train station  
10 min. to city centre  
  
Direct connection to two  
long distance train stations  
  
Shuttle to airport train station
- › Disabled access From the moment you arrive in  
Düsseldorf until you reach the trade  
fair itself, everything is arranged to  
suit your requirements.



### RIGHT IN THE HEART OF THE ACTION

- › 11.4 million residents in the Rhine-Ruhr region (1 hour by car)
- › 155 million people within a radius of 310 miles (50 % of the purchasing power  
and 31 % of the total population of the EU)
- › 1 hour by air to Amsterdam, Berlin, Copenhagen, London, Milan, Paris, Prague, Zurich ...
- › 77 airlines flying to more than 180 destinations in 50 countries

» [www.messe-duesseldorf.com/arrival](http://www.messe-duesseldorf.com/arrival)



## FACTS THAT SPEAK FOR THEMSELVES

### CONVENTION/EVENT FACILITIES

- › CCD total:  
7,500 people  
37 variable space units for up to 2,100 people
- › Total for CCD east:  
650 people  
Divisible into three separate units  
Large backstage area  
VIP apartment
- › Current parking options:  
P3: 230 parking spaces  
P4: 400 parking spaces  
P5: 500 parking spaces  
P1 + P2: 20,000 parking spaces

- › Hall 6:  
Up to 10,000 people
- › Halls 8a + b:  
5,000 people each  
Up to 9 rooms for 26 to 199 people

### FOR THE BIGGEST IDEAS

- › HORISUM concept:  
one of the world's largest event centres  
with more than 330,000 sqm of event floor area  
(arena and 18 trade fair halls)

» [www.d-cse.com](http://www.d-cse.com)

## ONGOING

### OUR 2030 MASTER PLAN

- › Time frame 2000 – 2030
- › Level of investment 636 million euros, non-subsidised
- › Scope
  - Modernisation of all trade fair halls and all customer spaces
  - New construction of trade fair halls 1, 6, 7a, 8a, 8b
  - Convention centre renovation
  - Creation of new event, convention, conference and seminar spaces
  - New construction of the north and south entrances

### WHAT WE'VE DONE SO FAR

- › New construction of trade fair halls 6, 7a, 8a, 8b
- › New construction of the north entrance with direct connection to the „Arena / Messe Nord“ underground station
- › Complete renovation of halls 4, 5, 10, 11, 12, 13, 14
- › Installation of a new combined heat and power unit; 2 solar PV plants brought online

### WHAT WE'RE PLANNING TO DO NEXT

- › New construction of the south entrance and trade fair hall 1





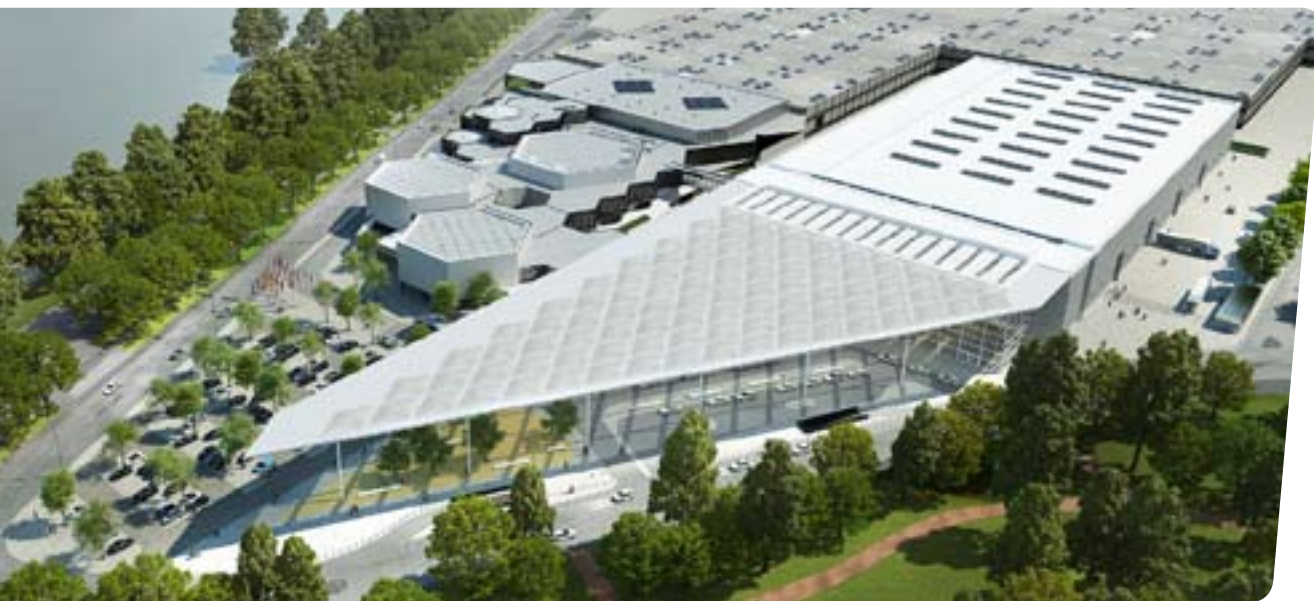

## TOP-NOTCH

THE NEW ENTRANCE AND NEW CONSTRUCTION OF HALL 1

» [www.messe-duesseldorf.com/construction](http://www.messe-duesseldorf.com/construction)

### SOUTH ENTRANCE / FOYER

- › Surface area 2,112 sqm (usable event space)
- › Length/width/height 93.00 m / 40.00 m / 20.00 m
- › Ceiling height 17.50 m

### AWNING

- › Surface area 7,800 sqm
- › Height 20 m
- › Mesh material Transparent fibreglass with LED lighting
- › Other facilities Underground car park entrance (300 parking spaces)  
160 above-ground parking spaces  
Bus stops / taxi stands  
2 direct crossings to the adjacent Nordpark

### HALL 1

- › Surface area 12,025 sqm
- › Length/width/height 158.34 m / 77.40 m / 20.00 m
- › Ceiling height 15.00 m
- › Pillars None
- › Gates 6 gates, 5.50 m / 6.00 m (width/height)  
1 gate, 5.50 m / 6.80 m (width/height)
- › Hall floor Distributed weight 10 t/sqm  
Single load 50 t/sqm,  
distributed across 1.2 x 1.2 m  
Heavy transport traffic 60 t  
Forklift permissible gross weight 30 t
- › Suspended loads In 3.00 m x 3.00 m / 270 kg grid  
Single loads up to 3,500 kg

### EVENT FACILITIES

- › Hall Up to 10,000 people
- › 6 conference rooms (1st floor) With 200 sqm for every 198 people,  
optional central divider
- › Direct access to CCD



## GOOD TIMES ON THE RHINE

IN THIS VIBRANT CITY EVERYTHING  
IS POSSIBLE. WHETHER YOU'RE LOOKING  
FOR CULTURE, FASHION, ART OR SCIENCE –  
IT'S ALL HERE, RIGHT ON YOUR DOORSTEP.

### EFFICIENT. HOSPITABLE. COSMOPOLITAN.

- › State capital of North Rhine-Westphalia, Germany's most populous federal state with 18 million inhabitants
- › Around 600,000 residents
- › 56 colleges and universities, 12 Max Planck Institutes, 6 International Max Planck Research Schools and 11 Fraunhofer Institutes in the greater Düsseldorf area
- › 100,000 companies in the region including over 5,000 foreign businesses, with 450 Japanese companies in Düsseldorf alone
- › 230 hotels with more than 26,000 beds
- › In the old town centre alone: 300 pubs, bars, restaurants, cafés and brewery pubs

### EASY TO GET TO.

- › Düsseldorf Airport flies more than 22 million passengers to over 200 non-stop destinations around the world each year
- › 2 long distance train stations
- › Düsseldorf main train station with 1,000 connections daily
- › 1,300 taxis, 151 taxi stands
- › Rheinbahn bus and train transport network covering more than 870 miles
- › Well connected to the region's motorways

### NOW YOU HAVE ALL THE OPTIONS

- › [www.messe-duesseldorf.com](http://www.messe-duesseldorf.com)
- › [www.messe-duesseldorf.com/guestshows](http://www.messe-duesseldorf.com/guestshows)

#### PICTURE CREDITS

© Messe Düsseldorf/ Andreas Wiese Cover, Page 8   © Messe Düsseldorf/ Constanze Tillmann Pages 2, 12, 15   © Andreas Gefeller Pages 4–5   © Ansgar M. van Treeck Page 11  
© slapa oberholz pszczulny architekten CADMAN Page 16   © Giulio Coscia Page 18



Messe Düsseldorf GmbH  
P.O. Box 10 10 06 \_ 40001 Düsseldorf \_ Germany  
Tel. +49(0)2 11/45 60-01 \_ Fax +49(0)2 11/45 60-6 68  
[www.messe-duesseldorf.de](http://www.messe-duesseldorf.de)

Basis for  
Business

